

South Carolina Available Industrial Building



Powertex 32,450 Sq. Ft. Moncks Corner

Location: 311 Power House Road off US 52 North
Moncks Corner, SC
Berkeley County

Building Area:

1,000	Sq. Ft. Office
31,450	Sq. Ft. Mfg./Whse.
32,450	Sq. Ft. Total

Year Built: 1980

Condition: Good

Construction

Floor: Concrete
Walls: Insulated Metal
Roof: Insulated Metal
Columns: 50'x30' and 50'x25'

Clear Height: 15'4" (13'3" Under Beam) at Eaves
19'6" (17' Under Beam) at Center

Lighting: Mercury Vapor and Fluorescent

Heating: 100%

Air Conditioning: Office Only

Sprinkler: 100% Dry, Not Presently Connected

Truck Docks: 4 Docks Plus 2 Drive in Doors

Site: 10 Acres

Former Use: Plastic Bags Manufacturing

FOR LEASE/SALE

Date Available: Immediately

Lease: \$4.25/ Sq.Ft. Annually
Including Taxes and Insurance

Sale: Negotiable

COMMENTS:

UTILITIES

Electricity: Santee Cooper
3 Phase, 480 Volt

Gas: None

Water: Berkeley County Water at Street

Sewer: Septic Tank

TRANSPORTATION

Railroad: None

Interstate Access: I-26, 19 Miles
I-526, 27 Miles

Commercial Airport: Charleston International
26 Miles

For Additional Information Contact:
 SC Department of Commerce
 1201 Main Street, Suite 1600
 Columbia, SC 29201
 Tel. 803-737-0400



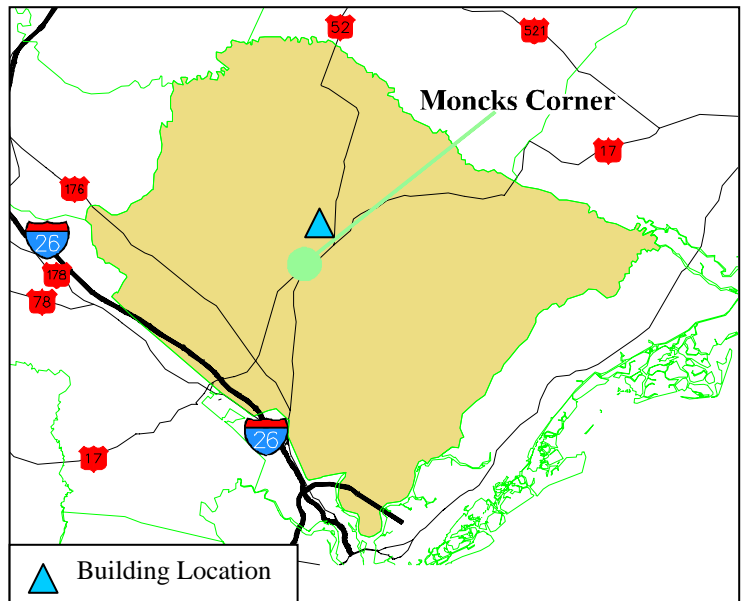
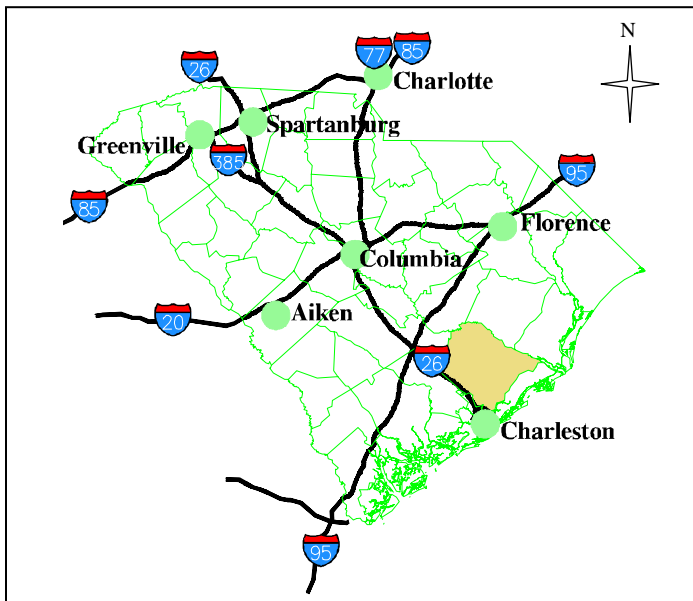
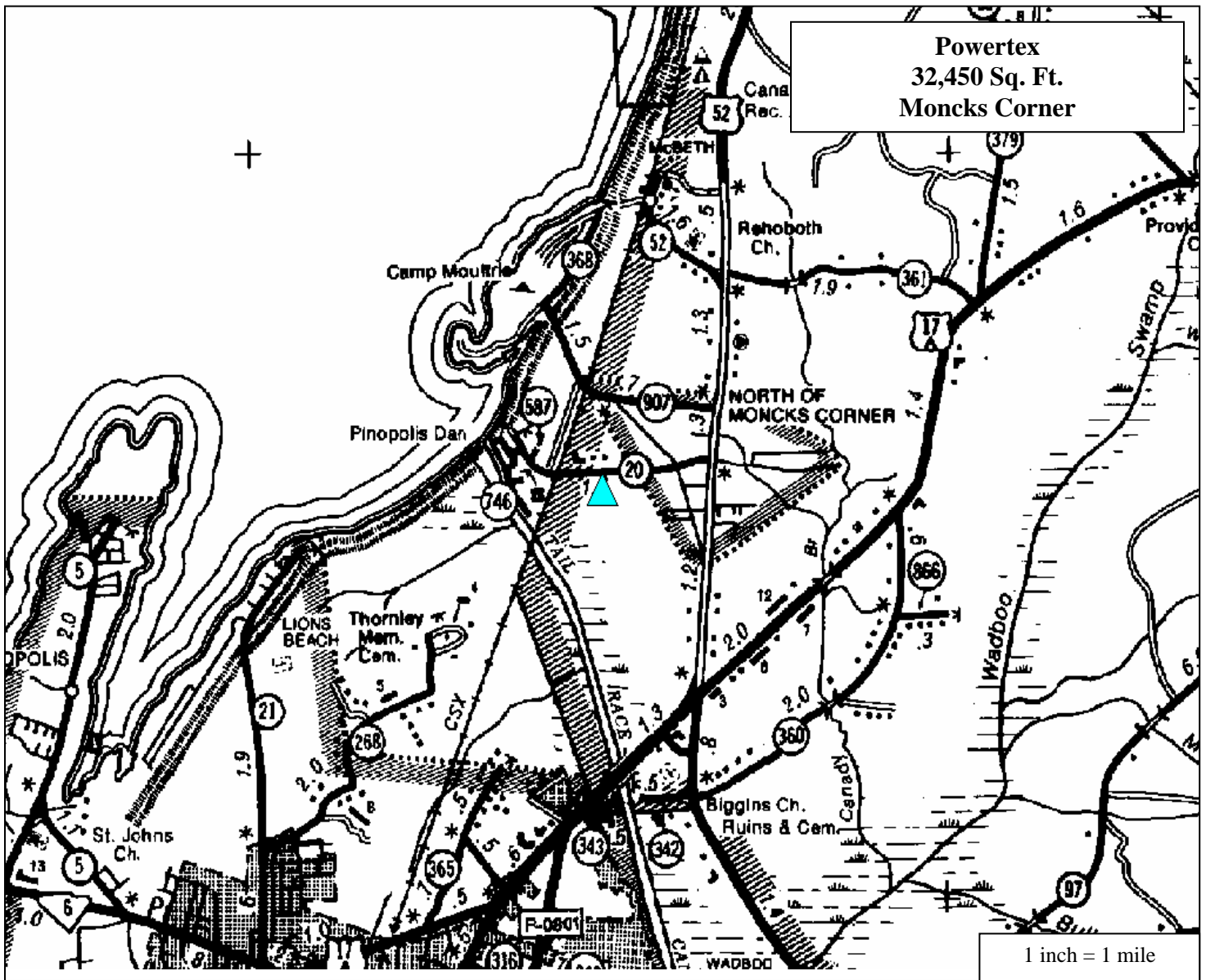

The South Carolina Department of Commerce, by providing this information, neither acts as an agent for the seller, buyer, lessor, nor lessee and provides this information solely pursuant to its public mandate to promote economic development within the State. The information provided by the Department of Commerce is derived from various sources and the Department of Commerce does not guarantee its accuracy nor make any representations concerning the suitability of the property for a particular purpose. Independent verification of any information should be sought by the user of the information. **Prepared: Sep 12, 2006**